

I Wall Cabinet

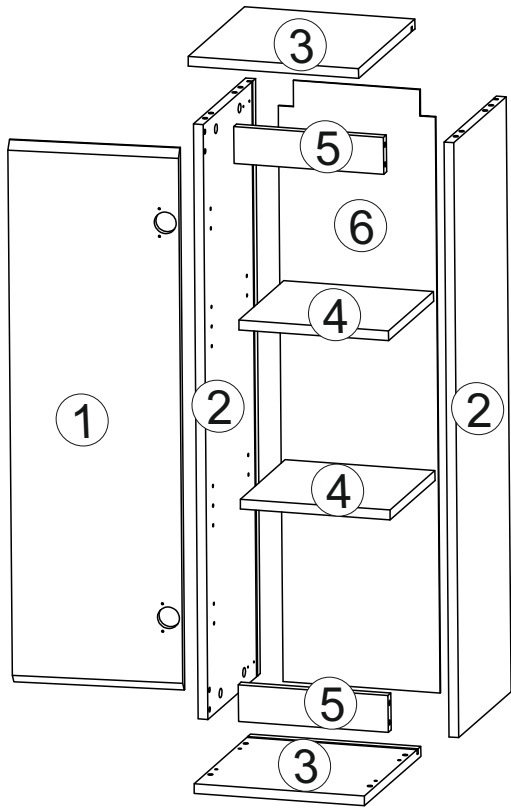

2x



A	B	C	D
1	LU1-001	884	274 1/2
2	LU1-101	970	284 1/2
3	LU1-201	280	306 1/2
4	LU1-301	244	246 1/2
5	LU1-401	246	60 1/2
6	LU1-901	258	982 1/2

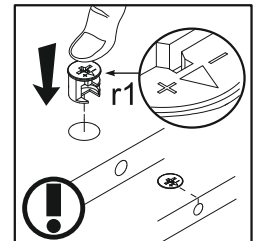
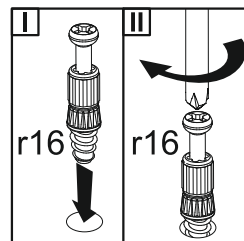
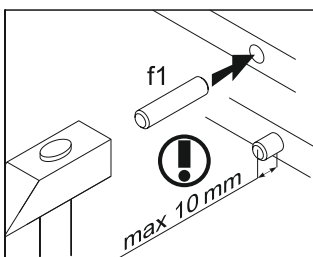
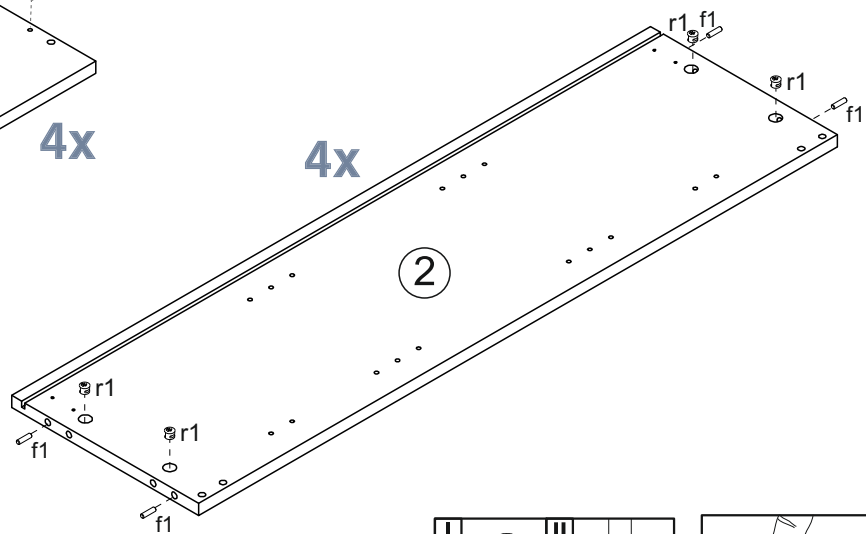
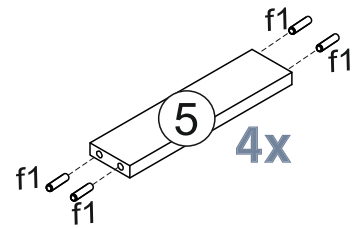
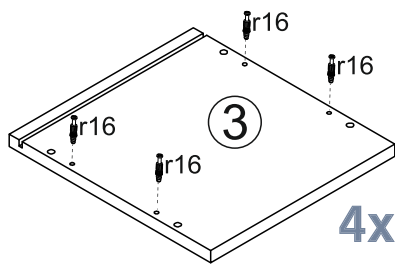
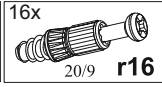
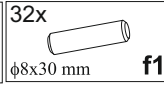
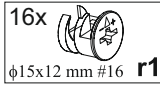

2



2x

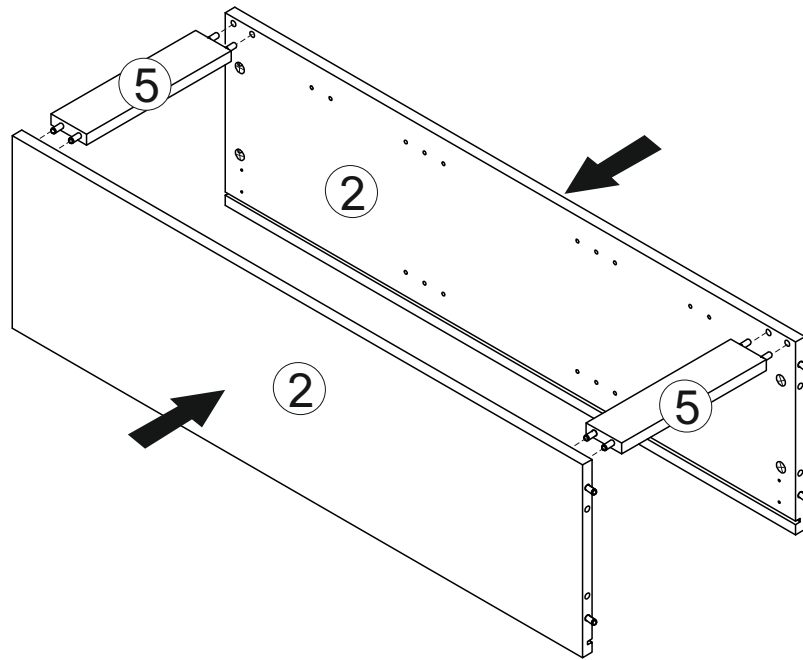

3

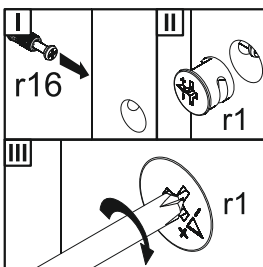
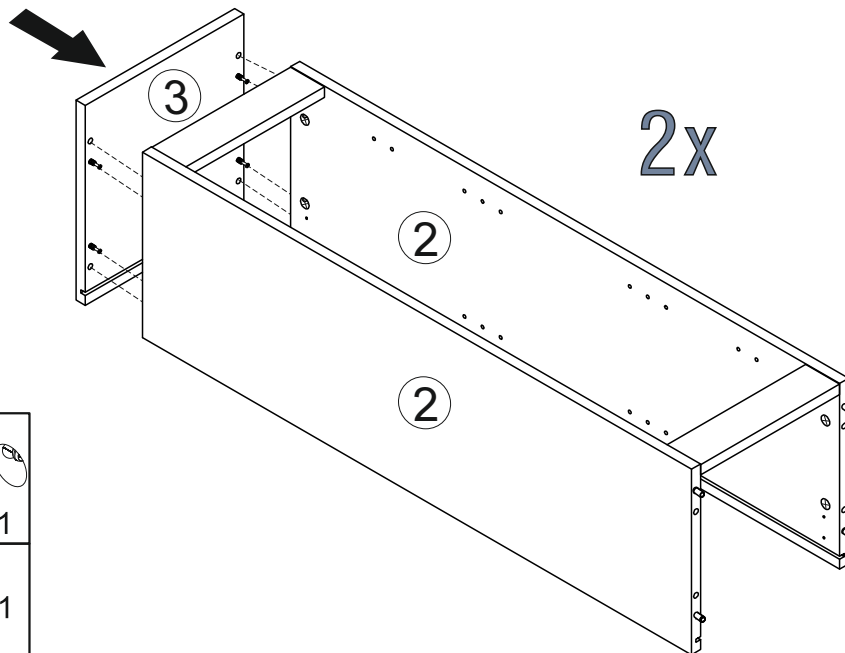

4

2x

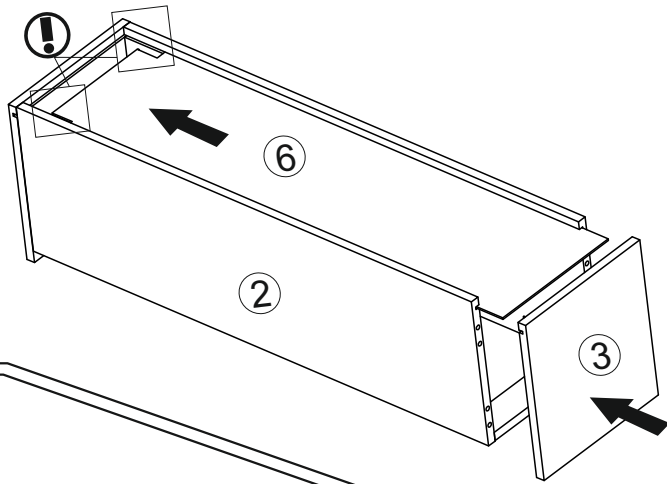
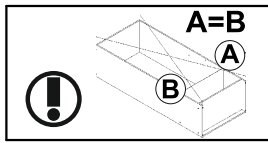

5

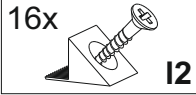

2x

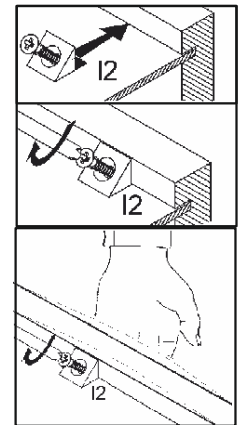
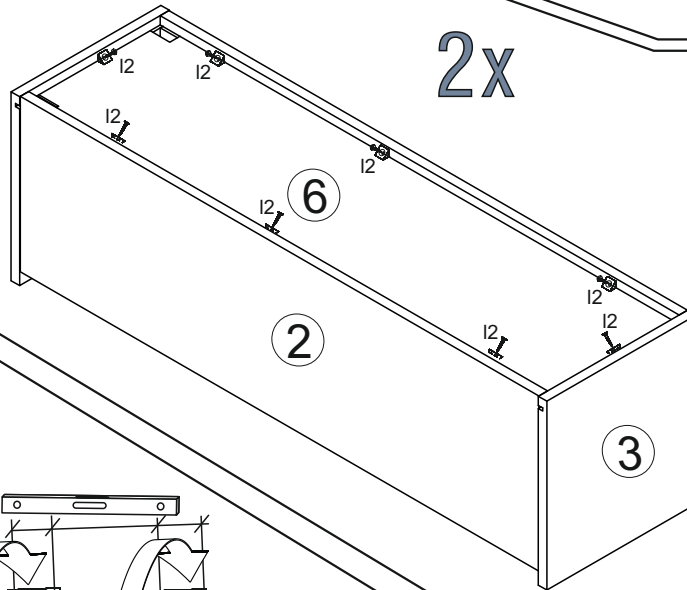
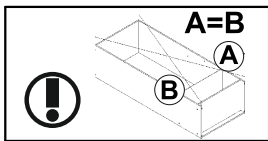

6

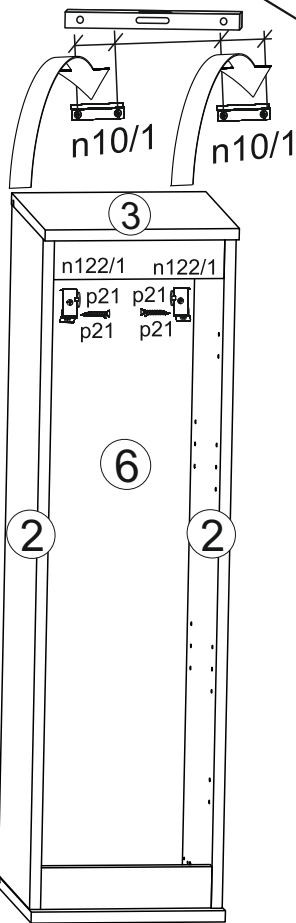
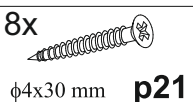
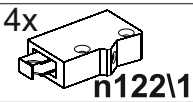
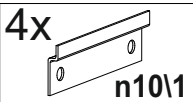
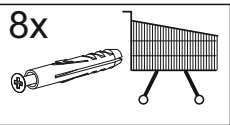

2x

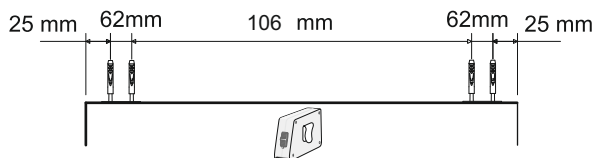
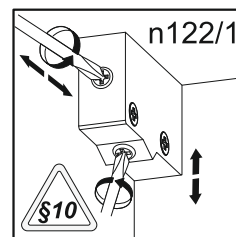
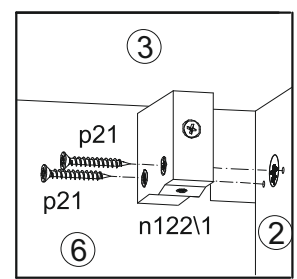
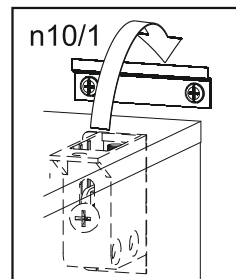
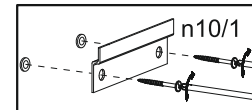
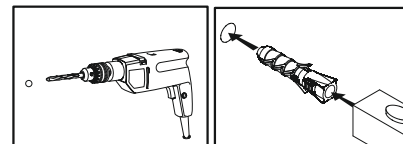

7

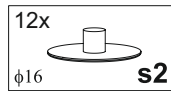
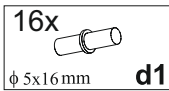
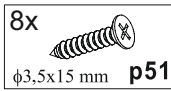
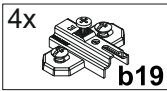
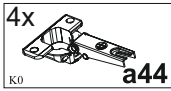

2x



REG1D_L

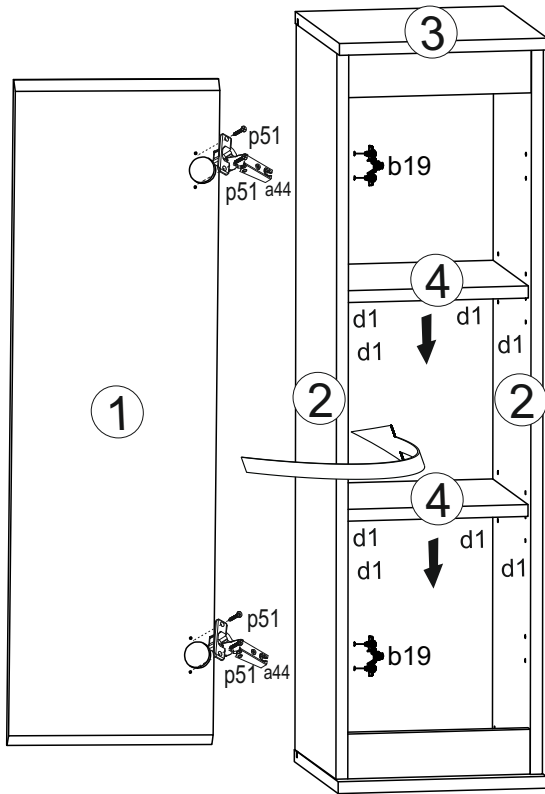

REG1D_P

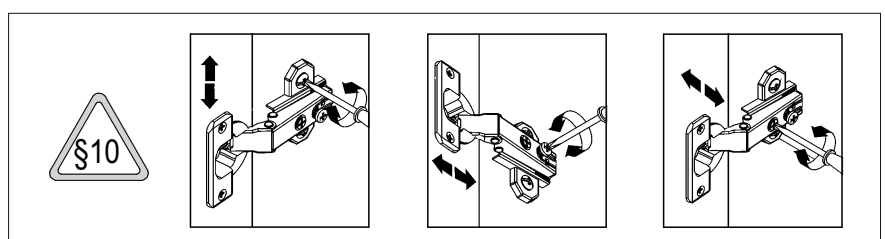
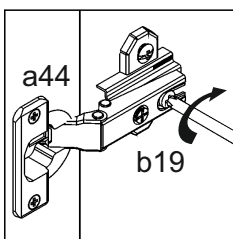
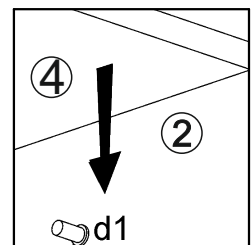
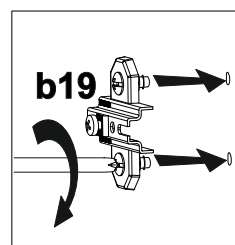
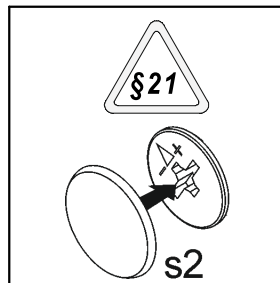
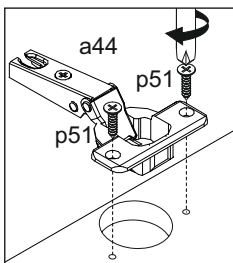
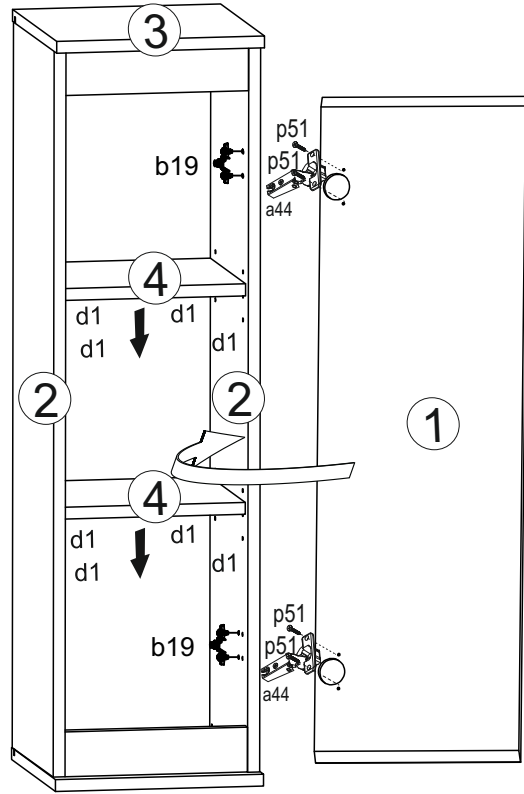



TV stand

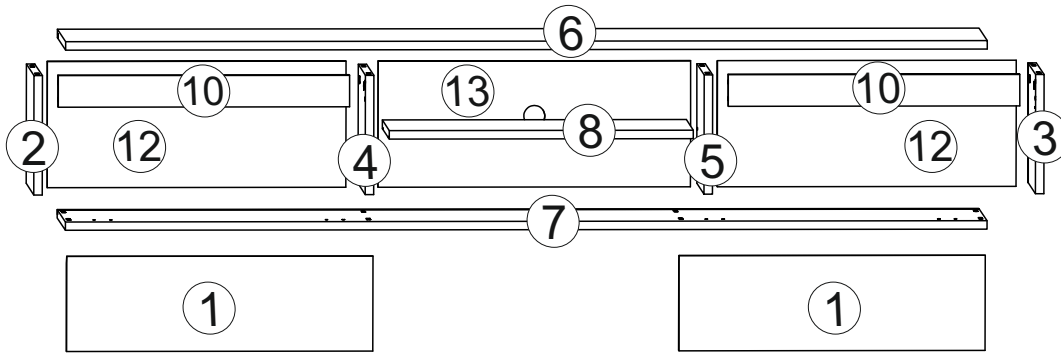

A	B	C	D
1	LU1-002	582	181
2	LU1-102	227	348
3	LU1-103	227	348
4	LU1-104	227	328
5	LU1-105	227	328
6	LU1-202	1752	370

A	B	C	D
7	LU1-203	1752	370
8	LU1-302	576	318
10	LU1-402	554	60
12	LU1-902	568	240
13	LU1-903	594	240

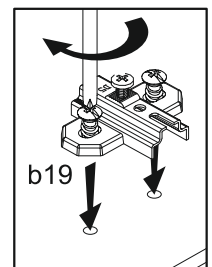
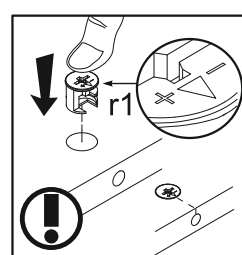
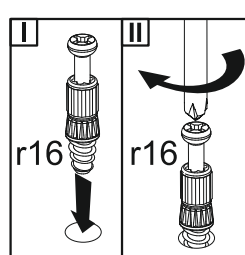
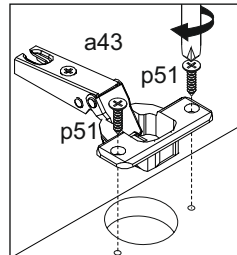
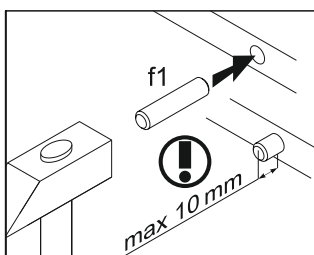
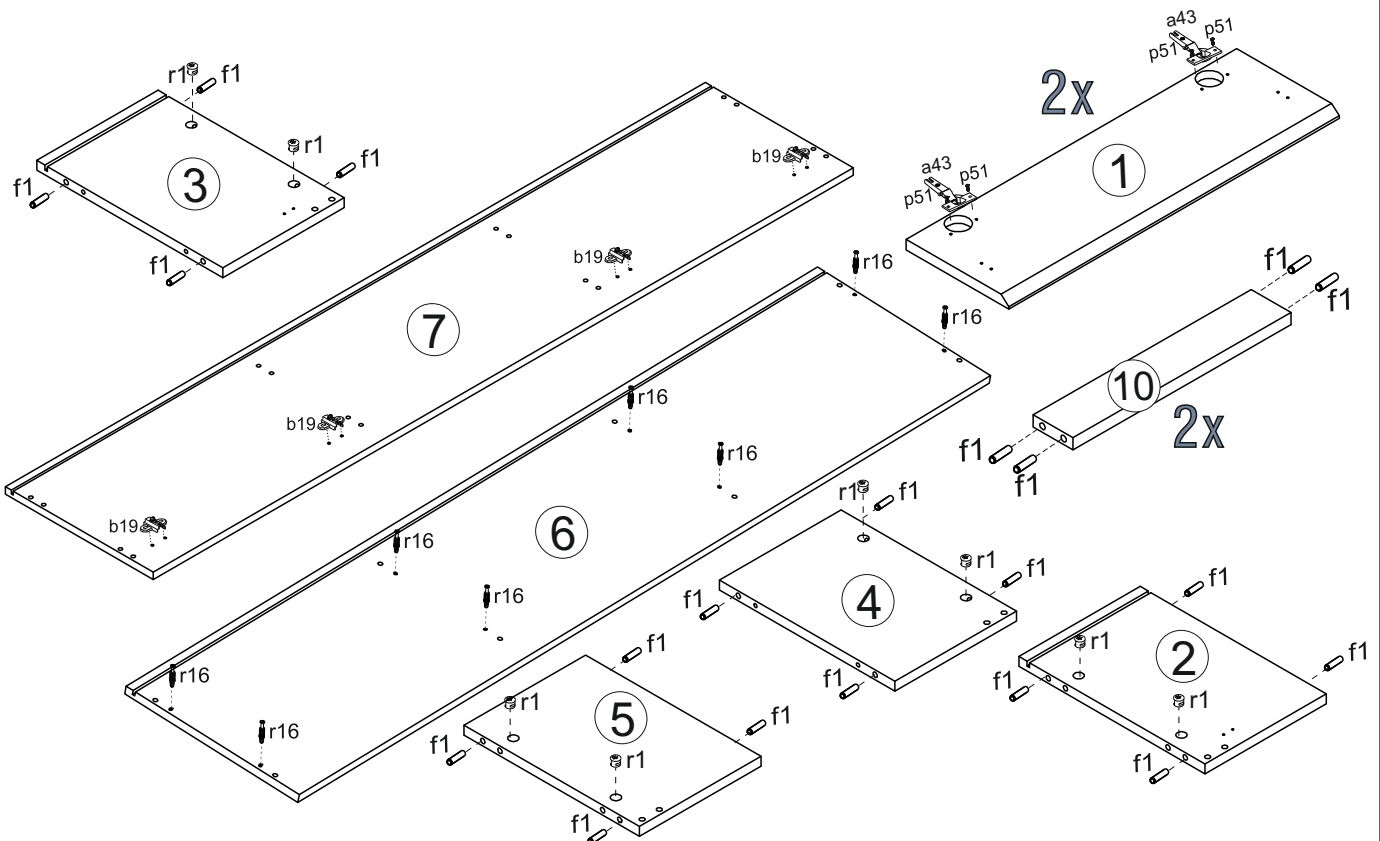
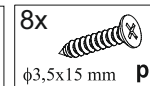
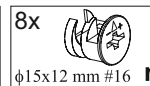
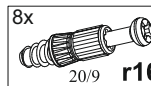
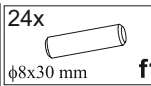
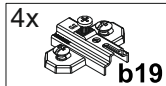
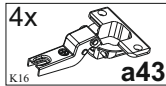

2

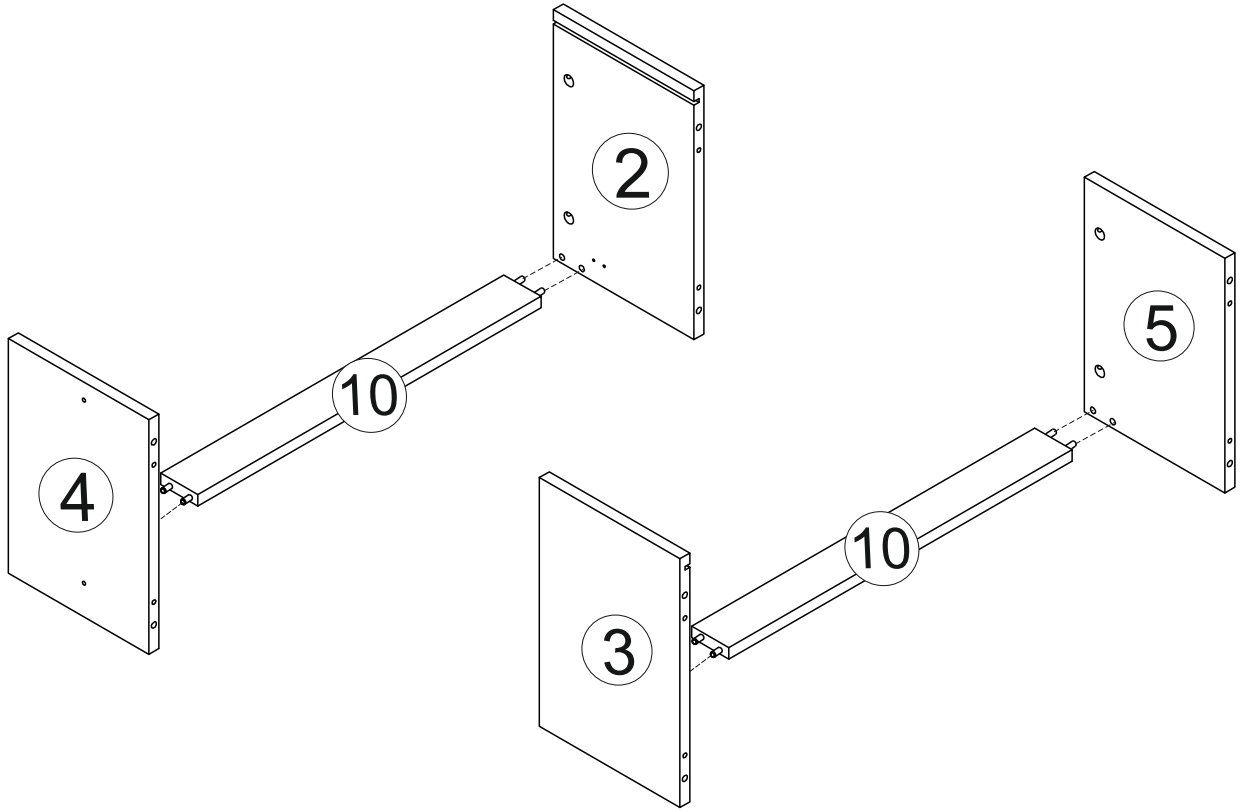

3

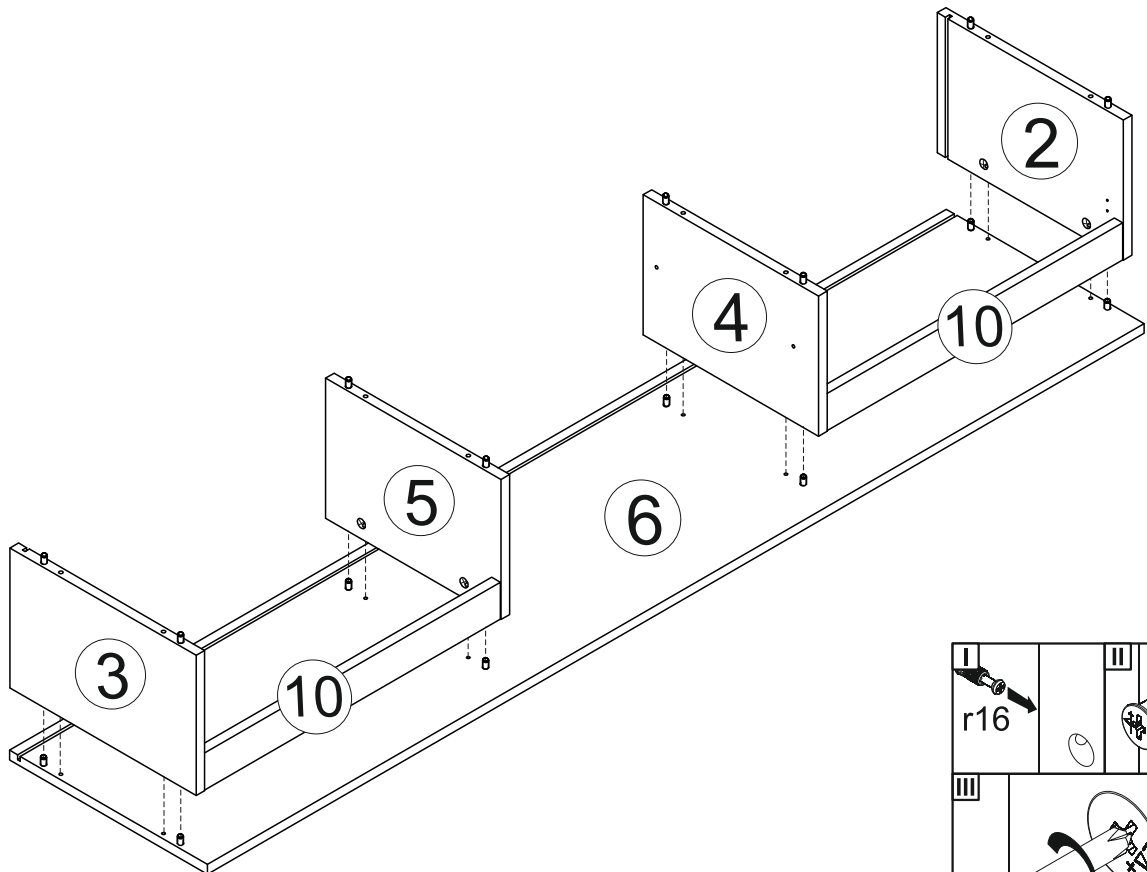

4

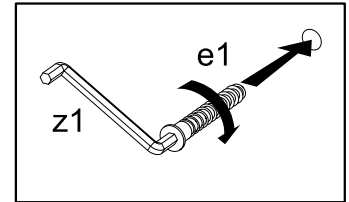
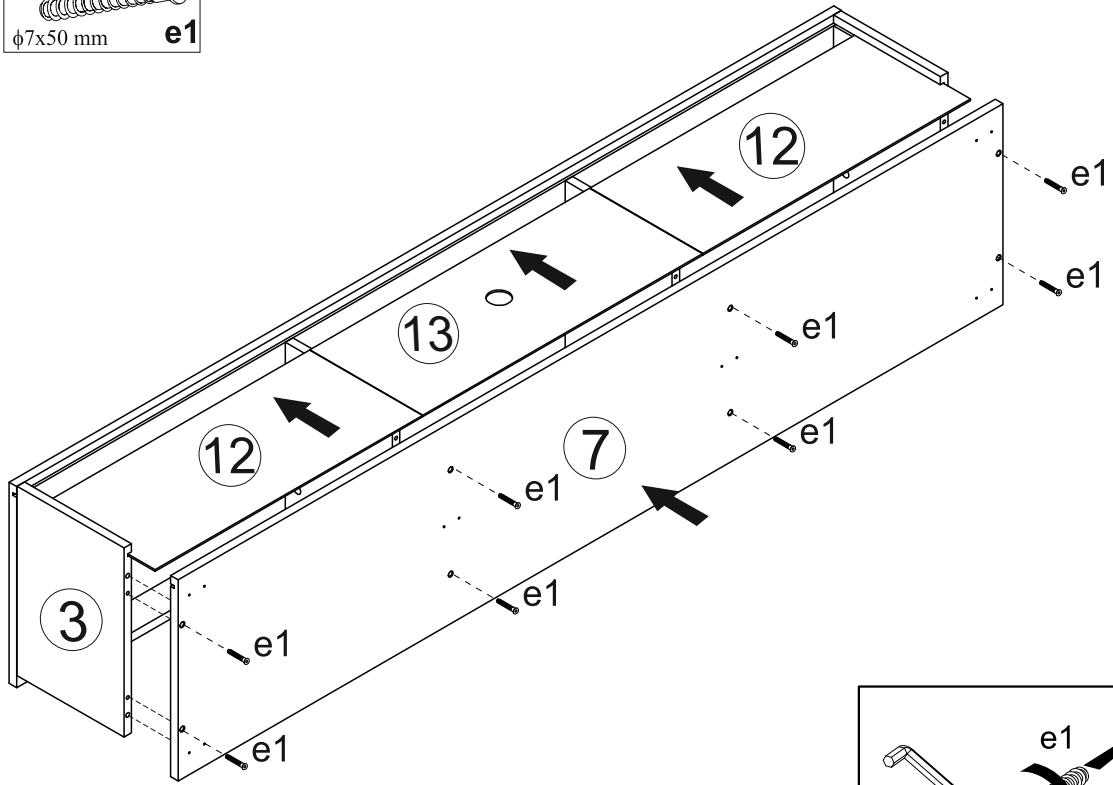
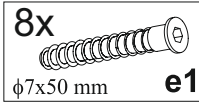

5

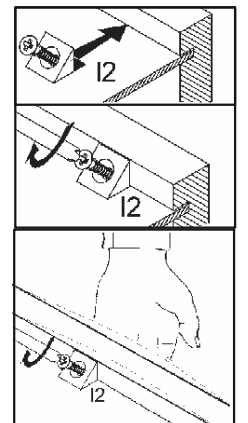
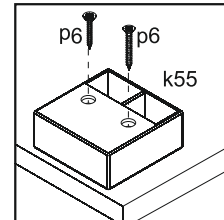
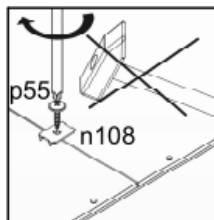
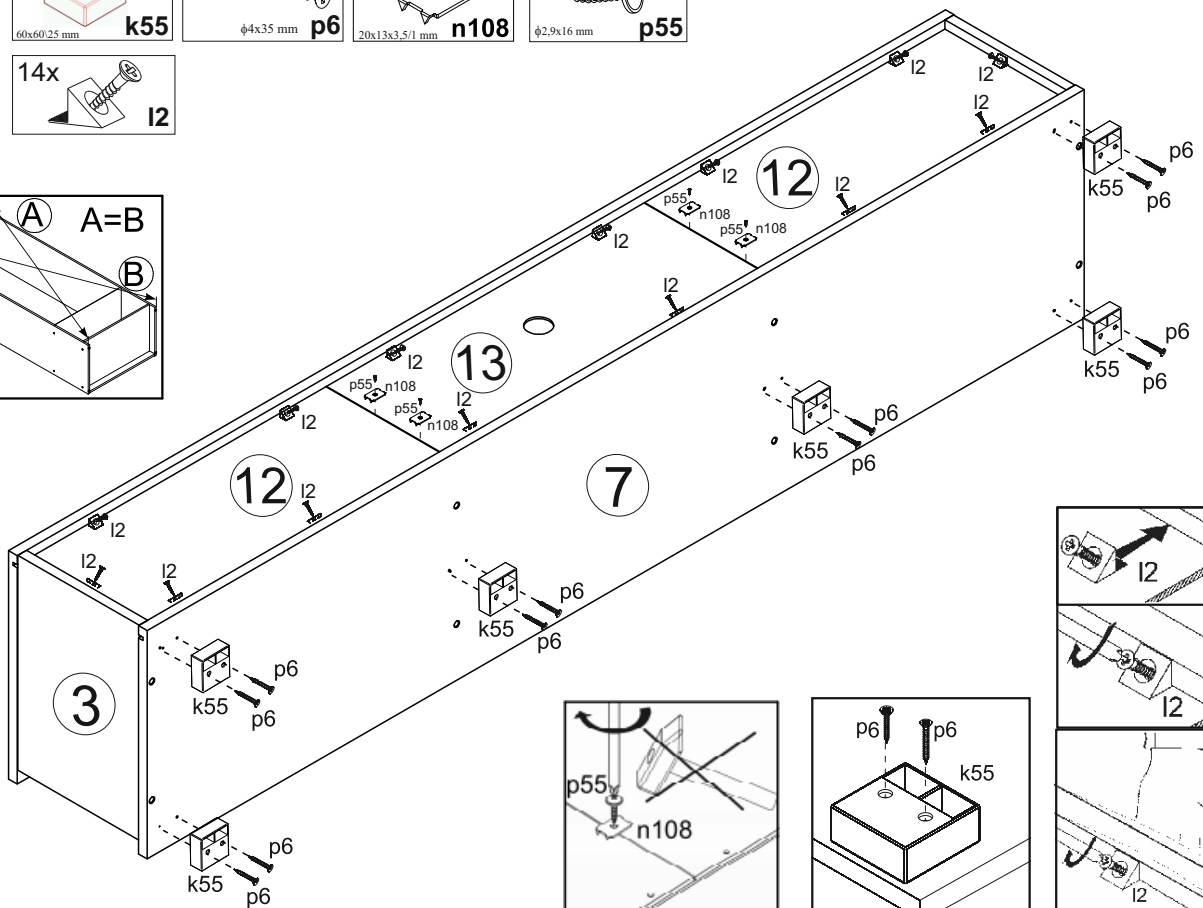
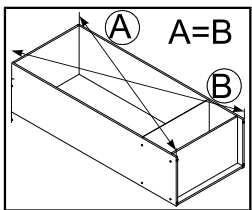
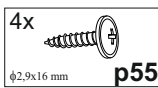
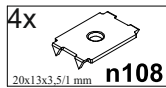
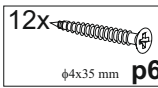
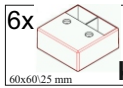

6

8x $\phi 3,5 \times 13$ mm p1

4x $\phi 5 \times 16$ mm d1

2x L-230 m48

8x $\phi 16$ s2

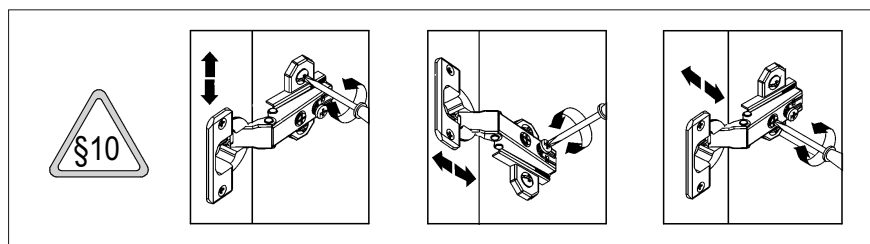
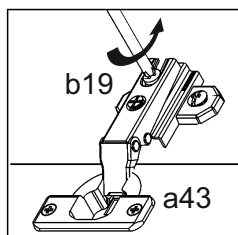
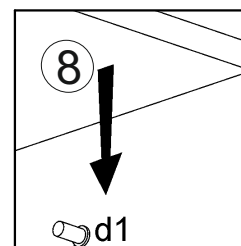
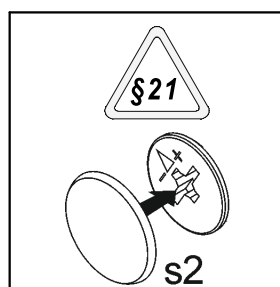
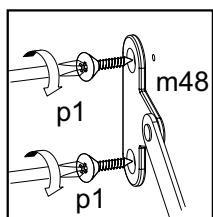
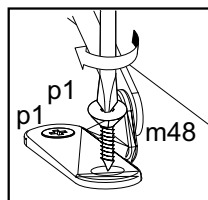
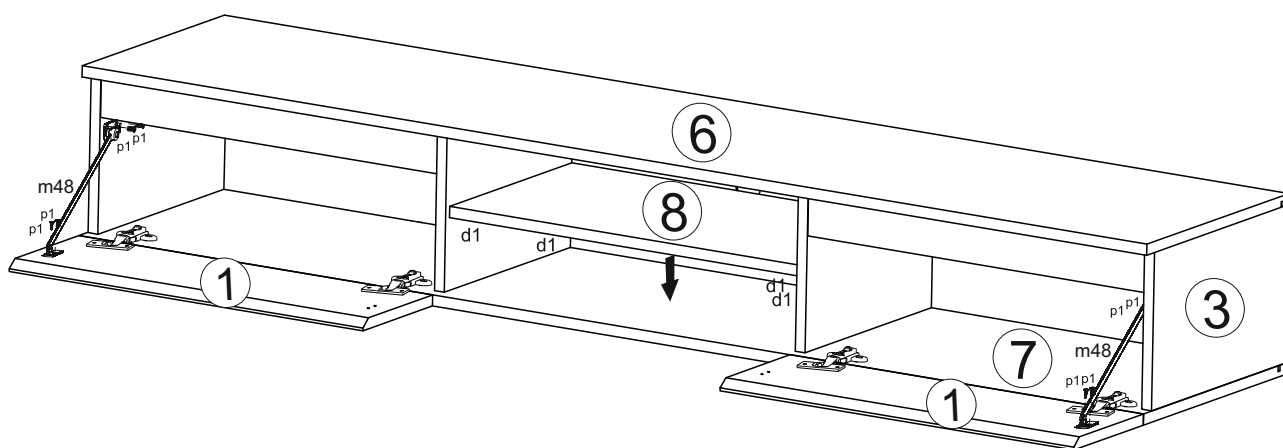



max
3kg

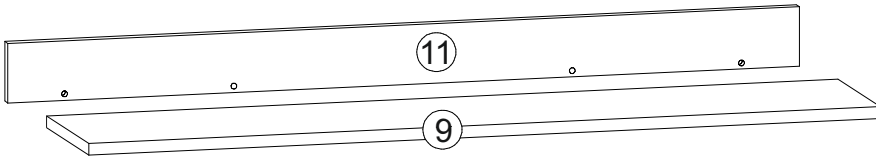

1

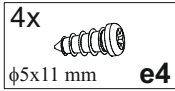
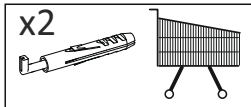

A	B	C	D	
9	LU1-303	882	144	2/2
11	LU1-403	982	150	2/2

